

## Required for Installation

You will need the following components and tools to install the antenna correctly.

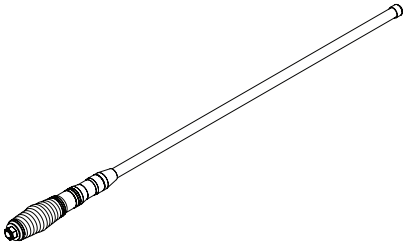

**1. Antenna**

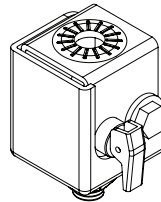

**2. Folding Bracket**

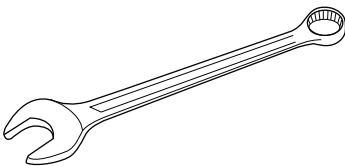

**3. 24mm Spanner**

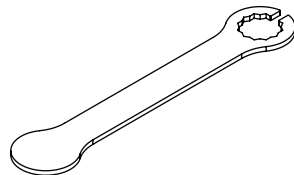

**4. 22mm Spanner (Provided)**

**Step 1**

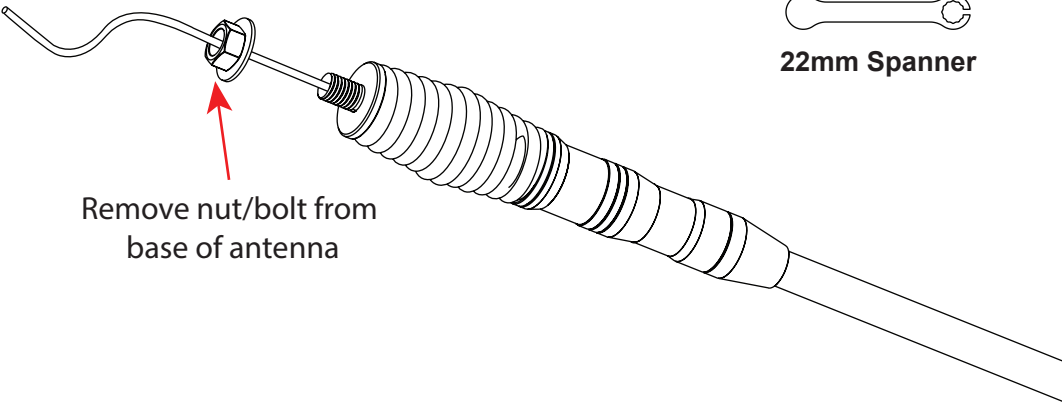

**Step 2**

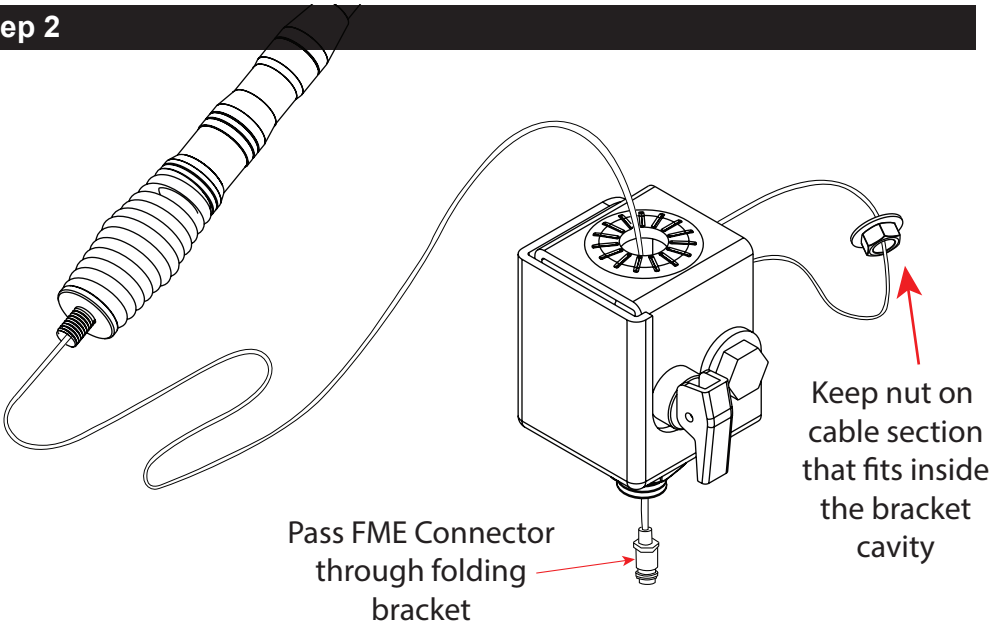

**Step 3**

Fit Antenna onto the  
top folding bracket  
via the hole

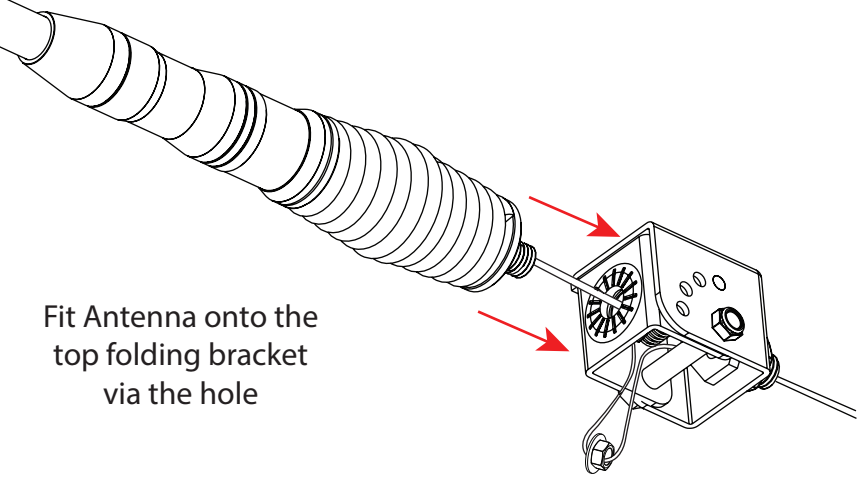

**Step 4**



**22mm Spanner**

use 22mm spanner provided  
to tighten antenna nut  
inside the folding bracket

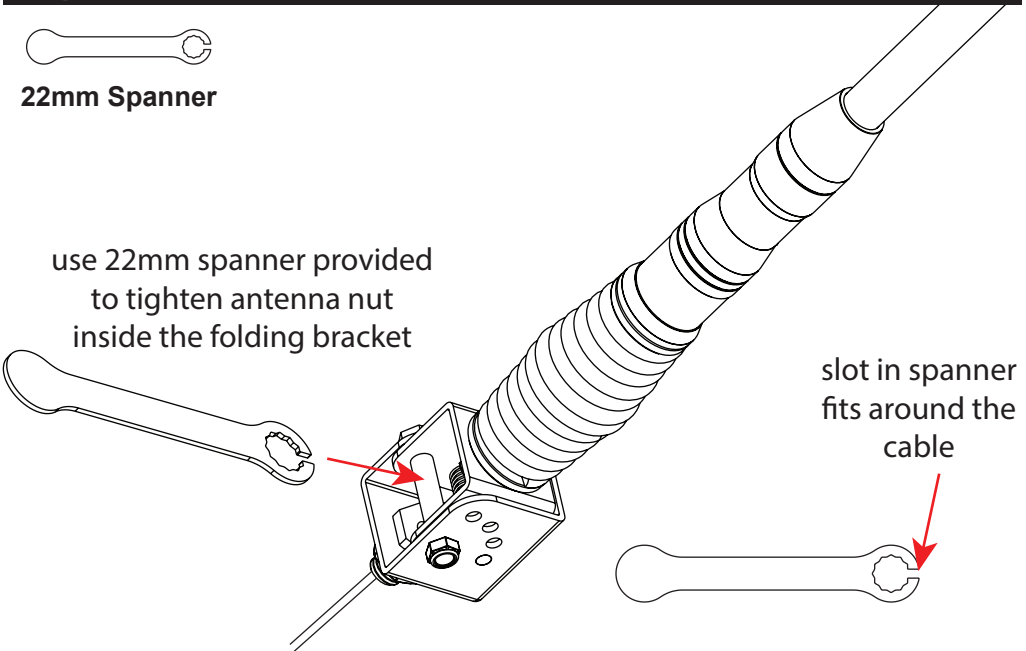

**Step 5**

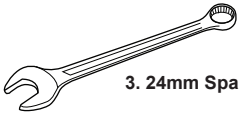

3. 24mm Spanner

Remove nut from  
from base of folding  
bracket

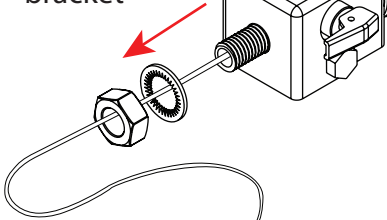

Feed cable through  
car where necessary



Mount Antenna  
in desired location  
on car

